

www.varitron.com.tw
www.c-var.com

VARITRON® 驅動科技系列產品 Gear Transmission Technologies

VARITRON®
Take Control In Speed

驅動科技系列產品
Power Transmission Technologies

台灣 中國變速工程股份有限公司
Varitron Engineering (Taiwan) Co., Ltd.

台灣新北市五股區中興路一段171巷45號
No.45, Ln.171, Sec.1, Zhongxing Rd.,
Wugu Dist., New Taipei City, Taiwan
TEL:+886-2-2988-9598
FAX:+886-2-2985-0998
EMAIL:sales@c-var.com

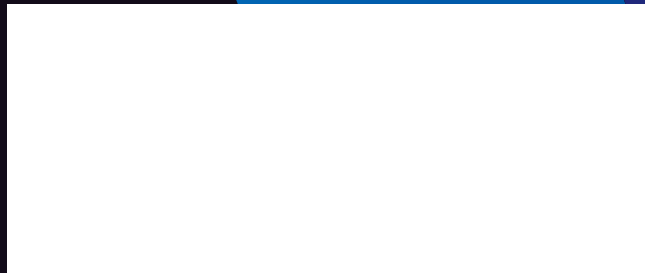

DISCO Speed Variator

Disco 無段變速機

VARITRON® Speed Variator is an integrate design with high efficiency, compact size, long life span and simple structure invention. It is the most highly used speed variator in modern industrial. Its torque transmission is by using fixed-star wheel friction, where stability, abrasion resistance and toughness are the best in variator device.



無段變速機為一結合高效率、體積小、壽命長、構造簡單於一身的完美發明，是目前各國先進國家使用率最高的機械式無段變速機，其扭力傳動方式，係利用多數平面滾動摩擦及自動調壓裝置結合而方，其穩定性、耐摩性及韌性是一般無段變速機所無法達到的特點，為一種真正能附合時代的專利產品。

Principle of Speed Change 操作原理

When the motor drives the fixed-star wheels(5)(6)to rotate, the planet wheel(8)is actuated to perform such functions as rotation and revolution due to pressure from the fixed – star wheel(5)(6), the outer ring(7) and speed regulating cam(9). Turn the handle to adjust speed of cam(9), steel-bearing ball ring(14), and radius of the fixed cam(15) and the controlling plate wheel(8). When the planet wheel(8) takes a revolution, it will cause the output shaft to turn one cycle. When the outer ring(7) and speed regulating cam(9) contact with the inner circle of planet wheel(8), it will prolong the time for revolution. This means that the slow-down of output will increase torque. (as below)

當馬達帶動太陽輪(5)(6)旋轉，游星片(8)受太陽輪(5)(6)及外環(7)、調速輪(9)的接壓，產生自轉及公轉，當把手轉動時，調速凸輪(9)，鋼珠(14)及固定凸輪(15)控制游星片(8)自轉及公轉的半徑距離，游星片(8)公轉一週，即輸出軸一轉。當外環(7)及調速凸輪(9)接觸游星片(8)內圓時，公轉的時間拉長，故輸出速度減慢，扭力增加。(如下圖)

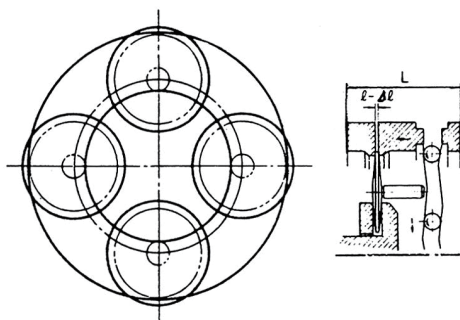

Highest Output Speed
出力軸迴轉速最高時

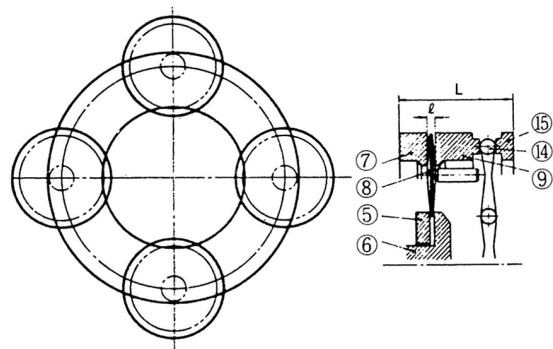

Lowest Output Speed
出力軸迴轉速最低時



Speed Variator Design Advantage Disco 無段變速機特長

Low Speed, High torque

VARITRON® speed variator ranging from 0.18kW to 22kW, its torque is conduct by multiple sets of bevel planetary disk, superior in handling over loading, impact and reverse impact. During low speed, plane wheel have larger contact thus high torque and high efficiency.

Totally Enclosed Design

VARITRON® speed variator is totally enclosed to ensure high performance under severe environmental. Speed variator that is inherently explosion-proof. Just add an explosion-proof motor, and you can have the adjustable speed versatility in a hazardous environment.

Speed Stability Within 1%

The speed adjustment setting remains stable over a long period of time with speed stability within 0.1%.

Compact, Light Weight with Modular Design

Modular design offers diversified configurations and excellent interfacing capability. With the use of various input attachments, a generic main body can have three different input options including input shaft, IEC adapter, and integral speed reducer.

Minimum Maintenance and Easy to Operate

Changes Speed through hand wheel, offers excellent performance at low output speed that is unparalleled by DC or inverter drives.

Wide range of applications

VARITRON® speed variator can be installed in any orientation with only a simple change of breather, oil filler hole, and drain plug locations.

低速時扭力變大效率高

無段變速機，輸入容量自0.18kw~22kw，其扭力的傳導是由多組斜面游星片的傳導，所以能夠承受過負載、衝擊負荷和反動作負荷的特殊環境，在低速時因游星片軌道擴大，故扭力變大效率特高。

全封閉機械式變速

無段變速機，經由機械方式變速，且全封閉在框架內，故在特殊場所，如爆炸性、易燃性、粉塵性、酸鹼性、潮濕性場所，只要馬達選用得當，均能適應沒有危險且壽命長。

穩定：速度變動率在1%以內

機械式變速的另一特色，就是速度穩定變動率低不會因環境溫升改變或使用過久而失去準確性。

體積小、重量輕、介面特性佳

本體1HP僅137mm長，體積小重量輕，且立式、臥式、雙軸型均可製造在整體的聯動系統中，可適用單一馬達驅動，降低成本、減少故障，提高系統聯動的特性。

變速操作容易

由於採用操作輪，變速容易，運轉中不管是否在負載狀態下，均可快速而確實地變速，並且可以裝用各種遙控裝置，與P.I.D.自動控制。

應用範圍廣泛

任何速度均可指定，任何角度均可安裝，不受入立軸轉速的限制，且能配合各種減速機使用。

Output Speed-Torque Table
出力軸迴轉速-轉矩曲線圖表

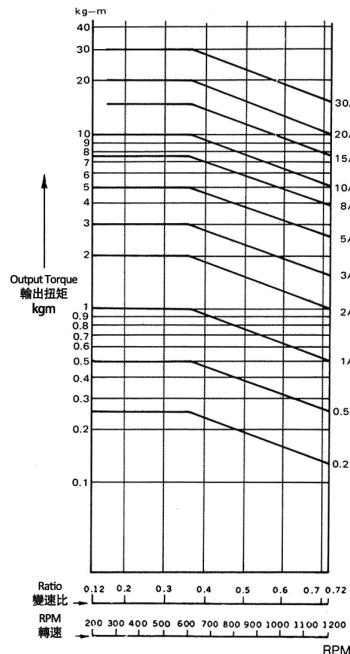
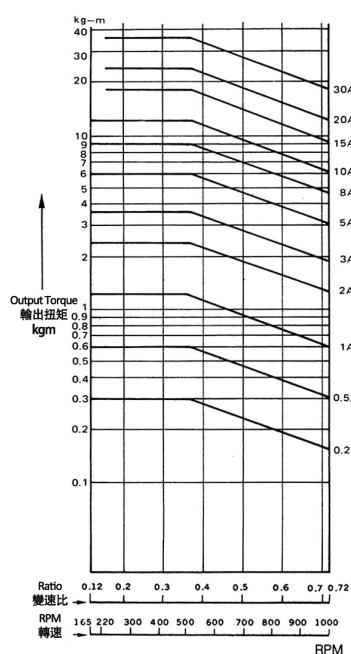

Construction Drawing 構造圖

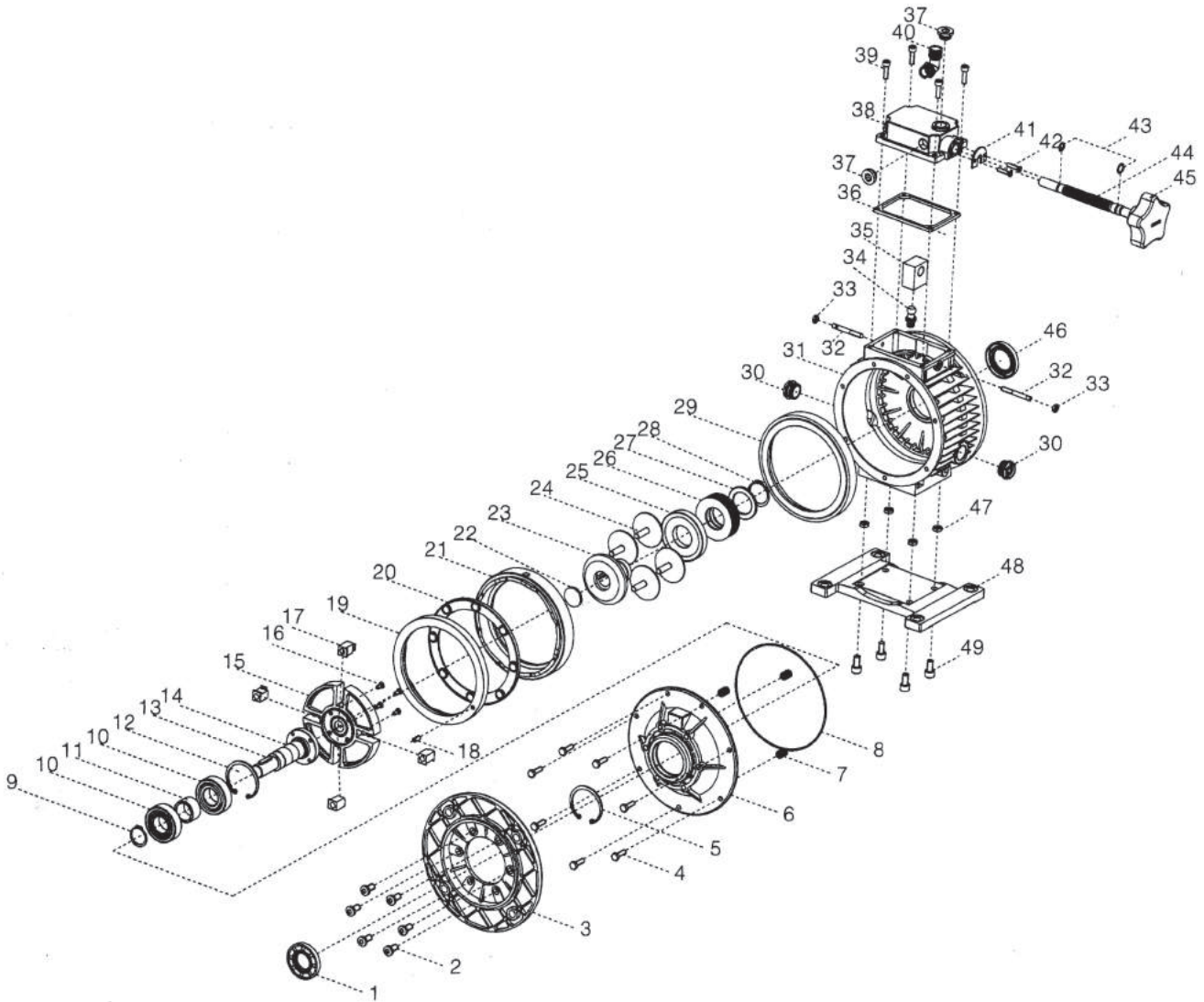

Item 項次	Component 零組件	Item 項次	Component 零組件	Item 項次	Component 零組件
1	Oil seal 油封	18	Elastic pin 彈性柱銷	35	Speed nut 調速螺母
2	Inner hex screw 內六角螺絲	19	Fixed CAM 固定凸輪	36	Rubber gaskets 橡膠墊片
3	Output flange 輸出法蘭	20	Ball ring 滾珠環	37	Oil plug 油塞
4	Hexagon Screws 外六角螺絲	21	Speed CAM 調速凸輪	38	Operating cover 操作蓋
5	Hole-Circlip R型扣環	22	Oil seal Cap 無孔油封	39	Inner hex screw 內六角螺絲
6	Output cover 輸出端蓋	23	Input active wheel 入力主動輪	40	Bent pipe 彎管
7	Spring 彈簧	24	Planet cone-disk 行星錐盤	41	Baffle 擋板
8	O-ring O形密封圈	25	Pressure plate 壓盤	42	Screws 螺釘
9	Shaft-Circlip C型扣環	26	Will spring 蝶形彈簧	43	O-ring O型密封圈
10	Bearing 軸承	27	Block circle 擋圈	44	Screw 絲杆
11	Shaft Collar 軸套	28	Shaft block 軸用擋圈	45	Speed control handle 調速把手
12	Hole-Circlip R型扣環	29	Internal planet ring 內遊星環	46	Oil seal 油封
13	Parallel key 平鍵	30	Oil guage 視油鏡	47	Nut 螺母
14	Output shaft 輸出軸	31	Housing 本體	48	Foot bottom 底腳
15	Turn arm 轉臂	32	Bolt 螺栓	49	Inner hex screw 內六角螺絲
16	Screws 螺釘	33	Nut 螺母		
17	Slider 滑塊	34	Ball head speed control handle 球頭調速柄		

How to order 選型

AM 5 - M1 - 1 - 2 -

.....
Option 選配

① ② ③ ④ ⑤ ⑥

①	Model 型式	AM: Foot Mount with Motor AVM: Flange Mount with Motor AK: Foot Mount with Input Shaft AV: Flange Mount with Input Shaft AHM: Integrated Gear Unit Foot Mount with Motor AHK: Integrated Gear Unit Foot Mount with Input Shaft TF: EU Type Aluminum Foot Mount TK: EU Type Cast Iron Foot Mount TXF: EU Type Aluminum Flange Mount TKF: EU Type Cast Iron Flange Mount	腳座型附馬達 法蘭型附馬達 腳座型入力軸式 法蘭型入力軸式 齒輪組腳座型附馬達 齒輪組腳座型入力軸式 鋁殼歐規腳座型 鑄鐵歐規腳座型 鋁殼歐規法蘭型 鑄鐵歐規法蘭型
②	Frame Size 型號	AM/AVM/AK/AV/AHM/AHK: 02,05,1,2,3,5,8,10 TF/TK/TXF/TKF: 002/005/010/020/030/050/100	
③	Operation Direction 使用方向	M1 (Standard 標準), M2, M3, M4, M5, M6 Refer to page 206. 參考第 206 頁	
④	Adjusting Wheel Position 調整輪方向	1 (Standard 標準) 2	
⑤	Terminal Box Direction 電器盒方向	1 / 2 (Standard 標準) / 3 / 4	
⑥	Reducer 減速機 (Optional 選項)	HX/VX: Cycloidal Drive 賽驅樂減速機 Page 55~60,72~77. 第 55~60,72~77 頁 NMRV: Worm Gear 萬向蝸輪減速機 Page 158. 參考第 158 頁 NMHV: Hypoid-Helical Gear Reducer Series 螺旋齒輪減速機系列 Page149 頁 HMW/LMW//UMW/TMW.: Cast Iron Worm Gear 鑄鐵蝸輪減速機 Page174 頁 GHM/GVM: Helical Gear Reducer 齒輪減速機 Page 126. 參考第 126 頁	

* Dimensions and specifications in the catalog are subject to change without notice. 尺寸及規格若有變動，將不另行通知。

* Optional Smart Monitoring System can be integrated, contact Varitron® or your sales personal. 如需加購智能監控系統，請洽中國變速。

Model 型式 ①

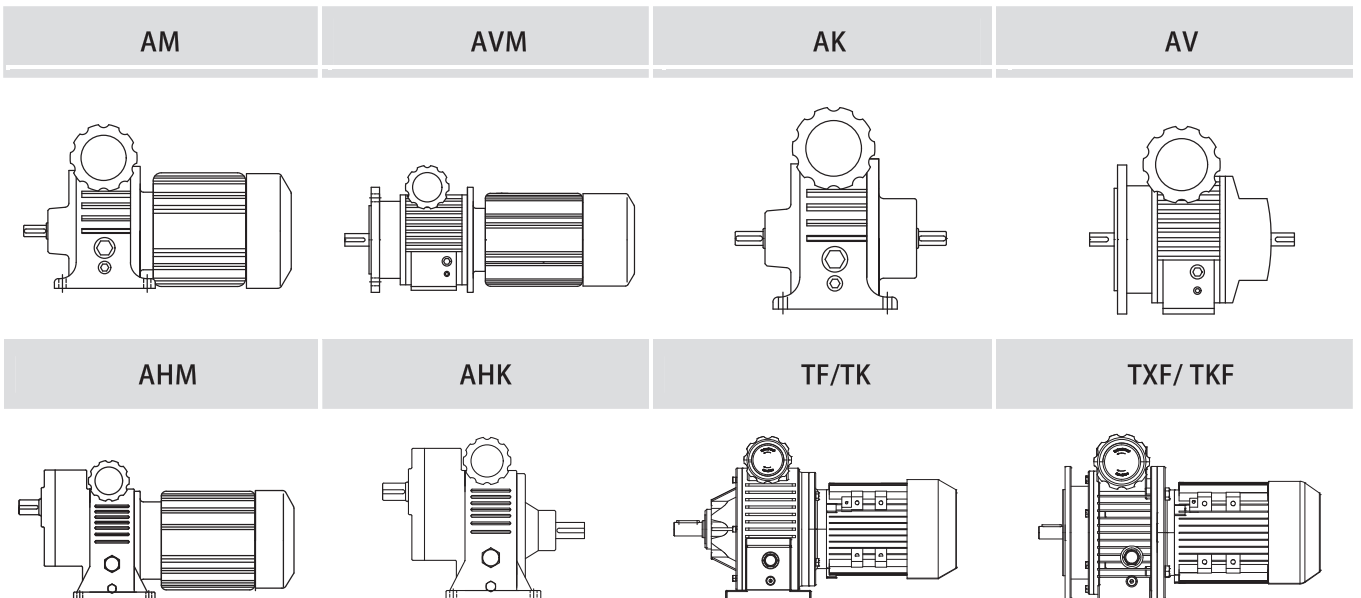

Operation Direction 使用方向 ③

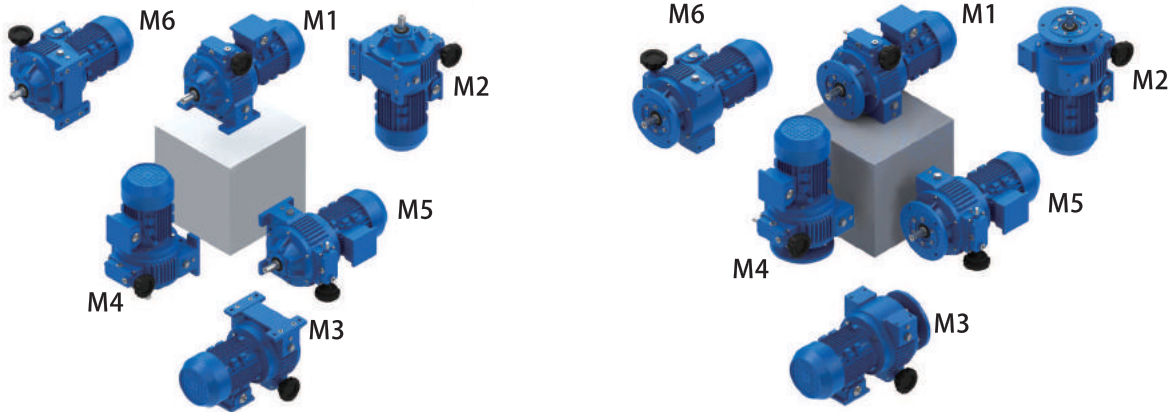

Adjusting Wheel Position 調整輪方向 ④

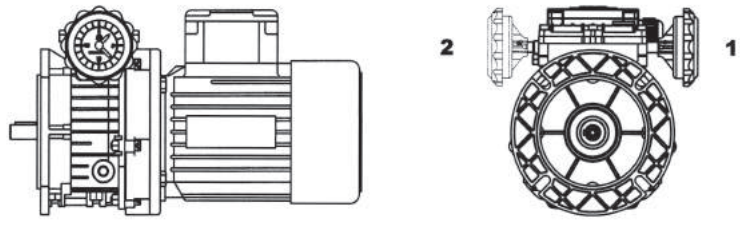

Terminal Box Direction 電器盒方向 ⑤

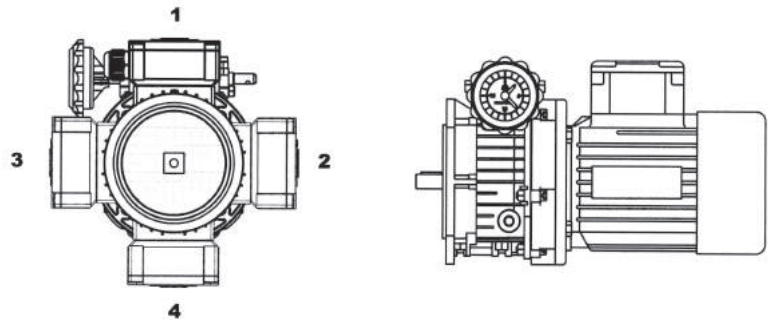

Model Photo 型式照片



Performance Chart 特性表

Standard type 基本型 AM. AVM. AK. AVK

Power 馬力 Hp(kW)	Frame Size 型號				Ratio 變速比	Speed Range 變速範圍	Revolution Speed 出力軸回轉速 rpm		Output Torque 出力軸轉矩 kg-m		Radial Load 容許外伸負荷 kg		Axial Load 容許推力負荷 kg	
	With Motor 附馬達型	Double Shaft 雙軸型	50Hz	60Hz			50Hz	60Hz	Input Shaft 入力軸	Output Shaft 出力軸	Input Shaft 入力軸	Output Shaft 出力軸		
													AM02	AVM02
1/4(0.18)	AM02	AVM02	AK02	AVK02	1 : 6	1/8.4~1/1.4	185~1000	200~1200	0.3~0.15	0.25~0.13	30	40	20	30
1/2(0.37)	AM05	AVM05	AK05	AVK05	1 : 6	1/8.4~1/1.4	185~1000	200~1200	0.6~0.3	0.5~0.25	40	80	35	50
1(0.75)	AM1	AVM1	AK1	AVK1	1 : 6	1/8.4~1/1.4	185~1000	200~1200	1.2~0.6	1~0.5	50	100	44	106
2(1.5)	AM2	AVM2	AK2	AVK2	1 : 6	1/8.4~1/1.4	185~1000	200~1200	2.4~1.2	2~1	75	130	82	130
3(2.2)	AM3	AVM3	AK3	AVK3	1 : 6	1/8.4~1/1.4	185~1000	200~1200	3.6~1.8	3~1.5	150	190	140	170
5(3.7)	AM5	AVM5	AK5	AVK5	1 : 6	1/8.4~1/1.4	185~1000	200~1200	6~3	5~2.5	150	190	140	170
7.5(5.5)	AM8	AVM8	AK8	AVK8	1 : 6	1/8.4~1/1.4	185~1000	200~1200	9~4.5	7.5~3.8	175	220	150	200
10(7.5)	AM10	AVM10	AK10	AVK10	1 : 6	1/8.4~1/1.4	185~1000	200~1200	12~6	10~5	175	220	150	200

EU type 歐規 TF. TXF. TK. TKF

Power 馬力 Hp(kW)	Frame Size 型號		Ratio 變速比	Speed Range 變速範圍	Revolution Speed 出力軸回轉速 rpm		Output Torque 出力軸轉矩 kg-m		Output Shaft Radial Load	Output Shaft Axial Load	IEC Input Adaptor IEC 入力法蘭
	Foot Mount 腳座型	Flange Mount 法蘭型			50Hz	60Hz	50Hz	60Hz	出力軸徑向	出力軸軸向	
									負荷 kg	負荷 kg	
1/4(0.18)	TF002	TXF002	1 : 5	1/8.2~1/1.6	170~880	210-1050	0.3~0.15	0.25~0.13	40	30	63M-B5
1/2(0.37)	TF005	TXF005	1 : 5	1/7~1/1.4	200~1000	240~1200	0.6~0.3	0.5~0.25	80	50	71M-B5
1(0.75)	TF010	TXF010	1 : 5	1/7~1/1.4	200~1000	240~1200	1.2~0.6	1~0.5	100	106	80M-B5
2(1.5)	TK020	TKF020	1 : 5	1/7~1/1.4	200~1000	240~1200	2.4~1.2	2~1	130	130	90L-B5
3(2.2)	TK030	TKF030	1 : 5	1/7~1/1.4	200~1000	240~1200	3.6~1.8	3~1.5	190	170	100L-B5
5(3.7)	TK050	TKF050	1 : 5	1/7~1/1.4	200~1000	240~1200	6~3	5~2.5	190	170	112M-B5
7.5(5.5)	TK100	TKF100	1 : 5	1/7~1/1.4	200~1000	240~1200	9~4.5	7.5~3.8	220	200	132S-B5
10(7.5)	TK100	TKF100	1 : 5	1/7~1/1.4	200~1000	240~1200	12~6	10~5	220	200	132M-B5

※ For 15Hp (11kW) and above model, contact Varitron® or your sales personal. 如需 15Hp(11kW)以上規格請洽中國變速。

Integrated Gear Unit 附齒輪組型 AHM. AHK

Power 馬力 Hp(kW)	Gear Ratio 齒輪 減速比 i	Frame Size 型號		Ratio 變速比	Speed Range 變速範圍	Revolution Speed 出力軸回轉速 rpm		Output Torque 出力軸轉矩 kg-m		Radial Load 容許外伸負荷 kg	
		With Motor 附馬達型	Double Shaft 雙軸型			50Hz	60Hz	50Hz	60Hz	Input Shaft 入力軸	Output Shaft 出力軸
1/4(0.18)	1/2.5	AHM02	AHK02	1 : 6	1/21~1/3.5	66~400	80~480	0.71~0.36	0.59-0.3	30	70
1/2(0.37)	1/2.5	AHM05	AHK05	1 : 6	1/21~1/3.5	66~400	80~480	1.43-0.71	1.19-0.59	40	110
1(0.75)	1/2.5	AHM1	AHK1	1 : 6	1/21~1/3.5	66~400	80~480	2.85-1.43	2.38-1.19	50	170
2(1.5)	1/2.5	AHM2	AHK2	1 : 6	1/21~1/3.5	66~400	80~480	5.7-2.85	4.75-2.38	75	330
3(2.2)	1/2.5	AHM3	AHK3	1 : 6	1/21~1/3.5	66~400	80~480	8.55-4.28	7.13-3.56	150	480
5(3.7)	1/2.5	AHM5	AHK5	1 : 6	1/21~1/3.5	66~400	80~480	14.3-7.13	11.9-5.94	150	480
7.5(5.5)	1/2.5	AHM8	AHK8	1 : 6	1/21~1/3.5	66~400	80~480	21.4-10.7	17.8-8.9	175	650
10(7.5)	1/2.5	AHM10	AHK10	1 : 6	1/21~1/3.5	66~400	80~480	28.5-14.3	23.8-11.9	175	650
1/4(0.18)	1/5	AHM02	AHK02	1 : 6	1/42~1/7	33~200	40~240	1.43-0.71	1.19-0.59	30	70
1/2(0.37)	1/5	AHM05	AHK05	1 : 6	1/42~1/7	33~200	40~240	2.85-1.43	2.38-1.19	40	110
1(0.75)	1/5	AHM1	AHK1	1 : 6	1/42~1/7	33~200	40~240	5.7-2.85	4.75-2.38	50	170
2(1.5)	1/5	AHM2	AHK2	1 : 6	1/42~1/7	33~200	40~240	11.4-5.7	9.5-4.75	75	330
3(2.2)	1/5	AHM3	AHK3	1 : 6	1/42~1/7	33~200	40~240	17.1-8.55	14.3-7.13	150	480
5(3.7)	1/5	AHM5	AHK5	1 : 6	1/42~1/7	33~200	40~240	28.5-14.3	23.8-11.9	150	480
7.5(5.5)	1/5	AHM8	AHK8	1 : 6	1/42~1/7	33~200	40~240	42.8-21.4	35.6-17.8	175	650
10(7.5)	1/5	AHM10	AHK10	1 : 6	1/42~1/7	33~200	40~240	57-28.5	47.5-23.8	175	650

AM/AK/AVM/AV/AHM Disco Speed Variator 無段變速機

Dimensions 外型尺寸表

寸法圖

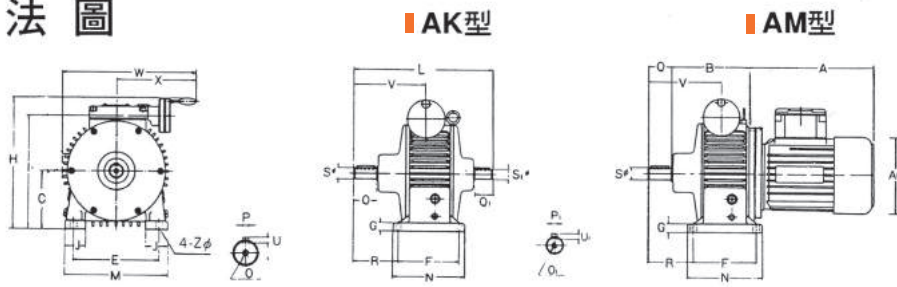

CAD 尺寸
gear.fyi/amc
50Hz=167~1000RPM
60Hz=200~1200RPM

Frame Size 型號	A	B	C	E	F	G	H	I	J	K	L	M	N	O	O ₁	P	P ₁	Q	Q ₁	R	S	S ₁	U	U ₁	V	W	X	Z	kg
AM02/AK02	187	100	71	110	105	12	188	170	25	25	240	140	125	M5	M5	5	5	30	25	48	14	14	5	5	99	191	121	9	18
AM05/AK05	210	115	90	130	105	15	218	190	32	30	246	160	135	M5	M5	5	5	30	30	60	14	14	5	5	110	229	149	10	26
AM1/AK1	227	137	106	160	125	15	249	226	40	40	285	190	150	M6	M6	6	6	40	30	75	19	19	6	6	129	266	166	12	36
AM2/AK2	288	173	125	180	140	18	313	246	50	45	300	230	165	M6	M6	8	8	50	40	80	24	24	8	8	157	310	190	12	59
AM3/AK3	315	208	150	245	230	20	378	298	55	50	366	300	270	M8	M8	8	8	60	50	85	28	28	8	8	187	370	220	14	87
AM5/AK5	355	208	150	245	230	20	378	298	55	50	396	300	270	M8	M8	8	8	60	50	85	28	28	8	8	187	370	220	14	103
AM8/AK8	405	249	200	315	250	30	475	389	70	80	540	365	290	M10	M10	10	10	70	60	90	38	38	10	10	211	435	250	18	230
AM10/AK10	445	249	200	315	250	30	475	389	70	80	540	365	290	M10	M10	10	10	70	60	90	38	38	10	10	211	435	250	18	238

※ Larger model available, contact Varitron® or your sales personal. 如需更大型號，請洽中國變速。

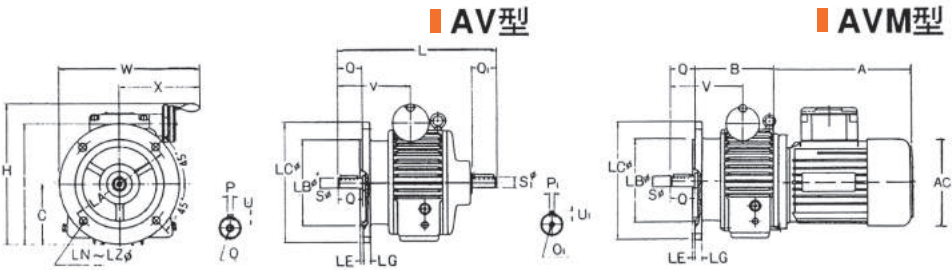

Frame Size 型號	B	C	H	I	L	LA	LB	LC	LE	LG	LN	LZ	O	O ₁	P	P ₁	Q	Q ₁	S	S ₁	U	U ₁	V	W	X	kg
AVM02/AV02	110	66	182	142	240	130	110	160	3.5	10	4	10	M5	M5	5	5	30	25	14	14	5	5	99	201	121	18
AVM05/AV05	115	87	215	174	246	130	110	160	3.5	12	4	12	M5	M5	5	5	30	30	14	14	5	5	110	249	149	26
AVM1/AV1	137	103	246	205	285	165	130	200	3.5	12	4	12	M6	M6	6	6	40	30	19	19	6	6	129	266	166	36
AVM1/AV2	173	120	308	241	300	165	130	200	4	16	4	15	M6	M6	8	8	50	40	24	24	8	8	157	315	190	59
AVM3/AV3	208	147	375	295	366	215	180	250	4	16	4	15	M8	M8	8	8	60	50	28	28	8	8	187	370	220	87
AVM5/AV5	208	147	375	295	396	215	180	250	4	16	4	15	M8	M8	8	8	60	50	28	28	8	8	187	370	220	103
AVM8/AV8	249	184	459	373	540	265	230	300	5	20	4	19	M10	M10	10	10	70	60	38	38	10	10	211	435	250	230
AVM10/AV10	249	184	459	373	540	265	230	300	5	20	4	19	M10	M10	12	10	70	60	38	38	10	10	211	435	250	238

※ Larger model available, contact Varitron® or your sales personal. 如需更大型號，請洽中國變速。

一段減速機 (減速比 1/2.5、1/5) AHM型

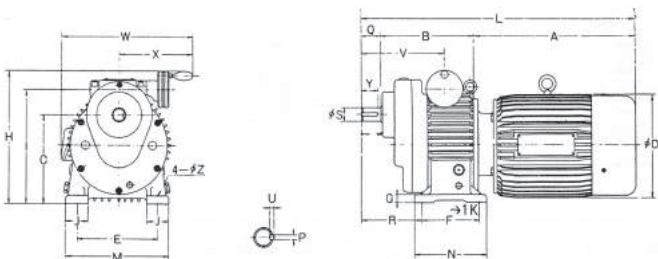

50Hz
1/2.5=67~400RPM
1/5=34~200RPM
60Hz
1/2.5=80~480RPM
1/5=40~240RPM

Frame Size 型號	A	B	C	D	E	F	G	H	I	J	K	L	M	N	P	Q	R	S	U	V	W	X	Z	kg
AHM02	210	117	106	145	110	105	12	188	170	25	25	357	140	125	5	30	68	16	5	116	270	121	9	22
AHM05	210	140	135	150	130	105	15	218	177	32	30	380	160	135	5	30	84	20	5	134	280	149	10	28
AHM1	227	171	160	170	160	125	15	249	208	40	40	433	190	150	7	35	104	25	7	158	307	166	12	38
AHM2	288	201	190	196	180	140	18	313	246	50	45	534	230	165	7	45	123	30	7	180	341	190	12	63
AHM3	315	246	224	196	245	230	20	378	298	55	50	621	300	270	10	60	123	40	8	260	378	220	14	97
AHM5	355	246	224	226	245	230	20	378	298	55	50	661	300	270	10	60	123	40	8	260	391	220	14	115
AHM8	405	290	290	284	315	250	30	475	389	70	60	760	365	290	12	65	144	50	10	260	461	250	18	265
AHM10	445	290	290	284	315	250	30	475	389	70	65	805	365	290	12	70	149	50	10	260	461	250	18	280

※ Larger model available, contact Varitron® or your sales personal. 如需更大型號，請洽中國變速。

TF/ TK/ TXF/ TKF EU Type Disco Speed Variator 歐規無段變速機

Dimensions 外型尺寸表

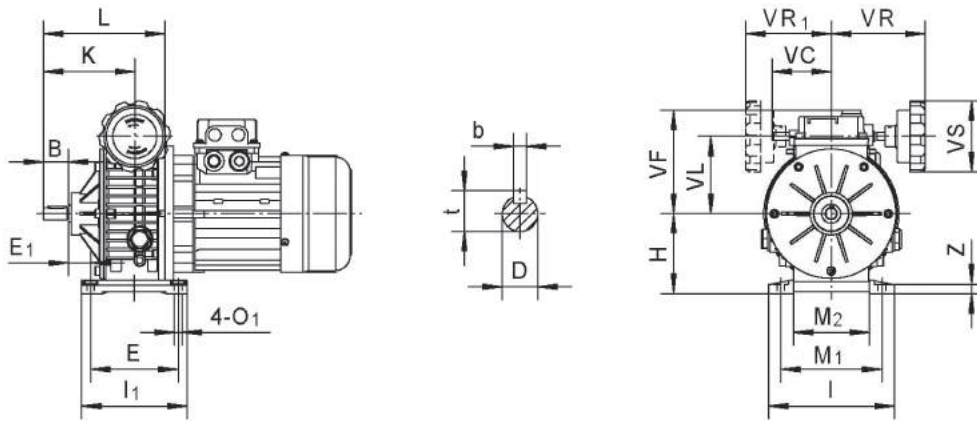

Frame Size 型號	B	D	E	E1	H	I	I1	K	L	M1	M2	O1	VF	VL	VR	VR1	b	t	Z
TF002	23	11	105	80	80	145	120	87.5	1355	110	71	9	111	78	110	110	4	12.5	10
TF005	30	14	104	93	93	149	125	104	140	120	96	9	123	90	110	110	5	16	10
TF010	40	19	125	113	113	190	150	125.5	179	160	135	11	140	107	120	120	6	21.5	15
TK020	50	24	140	123	123	241	150	165	238	180	143	12	144	122	150	-	8	27	18
TK030	60	28	230	150	150	300	270	191	268	245	190	14	188	150	160	-	8	31	25
TK050	60	28	230	150	150	300	270	191	268	245	190	14	188	150	160	-	8	31	25
TK100	70	38	250	200	200	365	290	201	319	315	245	18	-	192	194	-	10	41	30

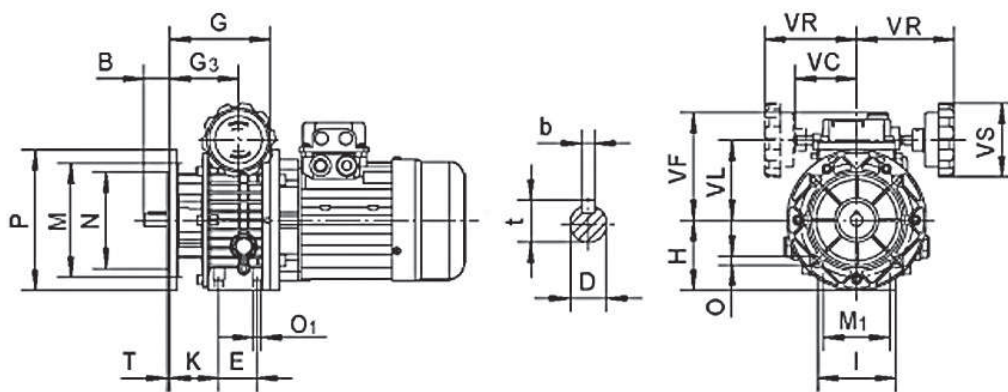

Frame Size 型號	B	H	D	G	G3	I	M	O	O1	P	T	VF	VL	VR	b	t
TXF002	23	70	11	112.5	64.5	72	115	9	M6	140	3.5	111	78	110	4	12.5
TXF005	30	80	14	110	74	90	130	9	M8	160	3.5	123	90	110	5	16
TXF010	40	100	19	139	85.5	98	165	11	M8	200	3.5	140	107	120	6	21.5
TKF020	50	126	24	188	115	241	165	11	-	200	3.5	144	122	150	8	27
TKF030	60	150	28	208	131	270	215	15	-	250	4	188	150	160	8	31
TKF050	60	150	28	208	131	270	215	15	-	250	4	188	150	160	8	31
TKF100	70	200	38	244	131	-	265	19	-	300	5	-	192	194	10	41

POWER TRANSMISSION INDEX

VARITRON®
Take Control In Speed

A1

Cycloidal Drive Reducer

賽驅樂減速機

HM



Pg.47

HX



Pg.55

H



Pg.61

VM



Pg.64

VX



Pg.72

V



Pg.78

Page
1~82

A2

RV Precision Cycloidal Gear

高精度擺線減速機

RV-E



Pg.84

RV-C

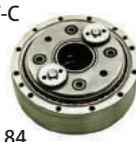

Pg.84

Page
83~84

B1

Precision Planetary Gearbox

精密行星減速機

DA



Pg.91

DM



Pg.93

DF



Pg.95

DH



Pg.97

DL



Pg.99

DN



Pg.101

Page
85~113

RAM-S



Pg.103

RAM-SS



Pg.104

RAM-H



Pg.105

RAM-D



Pg.106

RAM-F



Pg.107

RAH-S



Pg.109

RAH-SS



Pg.110

RAH-H



Pg.111

RAH-D



Pg.112

RAH-F

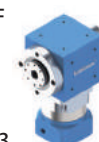

Pg.113

B2

Planetary Gear Reducer

遊星式減速機

HF



Pg.121

VF



Pg.122

HS



Pg.123

VS



Pg.124

Page
114~125

C1

Compact Helical Gear Motor Reducers

小型齒輪減速機

GH



Pg.130

GHM



Pg.131

GHD



Pg.132

GV



Pg.133

GVM



Pg.134

GVD



Pg.135

Page
126~135

C2

Helical Gear Motor Reducers

齒輪減速機

AMH



Pg.138

ADH



Pg.139

AMV



Pg.140

ADV



Pg.141

Page
136~141

POWER TRANSMISSION INDEX

C3

SEW Type Gear Reducer

歐規齒輪減速機

K



Pg.143

S



Pg.144

R



Pg.145

F



Pg.146

Page
142~146

C4

Industrial Helical Bevel Gearbox

齒輪箱

H



Pg.148

B



Pg.148

Page
147~148

D1

NMHV Hypoid-Helical Gear Reducer

萬向螺旋齒輪減速機

NMHV



Pg.156

NHV



Pg.157

Page
149~157

D2

NMRV Worm Gear Reducer

萬向蝸輪減速機

NMRV



Pg.168

NMRV-NMRV



Pg.169

NRV



Pg.170

NRV-NMRV



Pg.170

PC-NMRV



Pg.171

Page
158~173

D3

Worm Gear Speed Reducer

蝸輪減速機

HW



Pg.181

HMW



Pg.182

HOM



Pg.183

LW



Pg.184

LMW



Pg.185

HOW



Pg.186

Page
174~201

LOW



Pg.186

VW



Pg.187

VMW



Pg.188

VOW



Pg.189

VOM



Pg.190

UW



Pg.191

UMW



Pg.192

TW



Pg.193

TMW



Pg.193

TOW



Pg.194

TOM



Pg.194

VOF

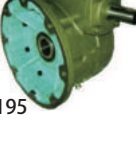

Pg.195

VOFM



Pg.195

LH



Pg.196

LHM



Pg.196

LOH



Pg.197

LOHM



Pg.197

VH



Pg.198

UH



Pg.198

VHM



Pg.199

UHM



Pg.199

VOH



Pg.200

VOHM



Pg.200

E1

Disco Speed Variator

無段變速機

AM



Pg.208

AK



Pg.208

AVM



Pg.208

AV



Pg.208

AHM



Pg.208

TXF



Pg.209

TKF



Pg.209

Page
202~209

E2

Belt Stepless Variable Speed Drive

皮帶變速機

APH



Pg.210

LW



Pg.211

HV



Pg.211

Page
210~211

E3

Five Steps Buffered Speed Changer

五段緩衝式變速機

LM



Pg.212

Page
212

E4

PIV Chain Variable Speed Drive

鍊條無段變速機

PIV-H



Pg.214

PIV-V



Pg.214

Page
213~215

F1

Spiral Bevel Gear Box

十字轉向機

LG



Pg.218

Page
216~218

F2

Spiral Screw Rod Actuators

螺桿升降機

SR



Pg.221

SRM



Pg.221

Page
219~222

G

Induction Electric Motor

感應馬達

AEEH/AEEP/AEES



Pg.228

AEVH/AEVP/AEVS



Pg.229

AEEH-ALB3



Pg.231

AEVH-ALB5



Pg.232

AEVH-ALB14



Pg.232

Page
223~232

H

Agitator Mixer

攪拌機

HHM



Pg.237

LW



Pg.238

GVV



Pg.239

CS/CSS



Pg.240

HMB



Pg.241

SC/SCB



Pg.242

Page
233~242